

PROVIDENCE, R. I.
CITY ENGINEER'S OFFICE.
STREET LINE DEPT.
Jan. 24, 1887
012552

Providence R.I.
This plat accompanies
our report of this date.

PLAT
OF A STREET FROM
THE WESTERLY LINE OF THE TOWN OF EAST PROVIDENCE TO GANO ST.
IN TWO SHEETS.
SCALE 50 FEET PER INCH.

735.35	717.79
67.15	67.15
183.11	186.89
985.61	971.83
	985.61
	2) 1957.44
	978.72

Named Tockwotton St. Mar. 17, 1887.

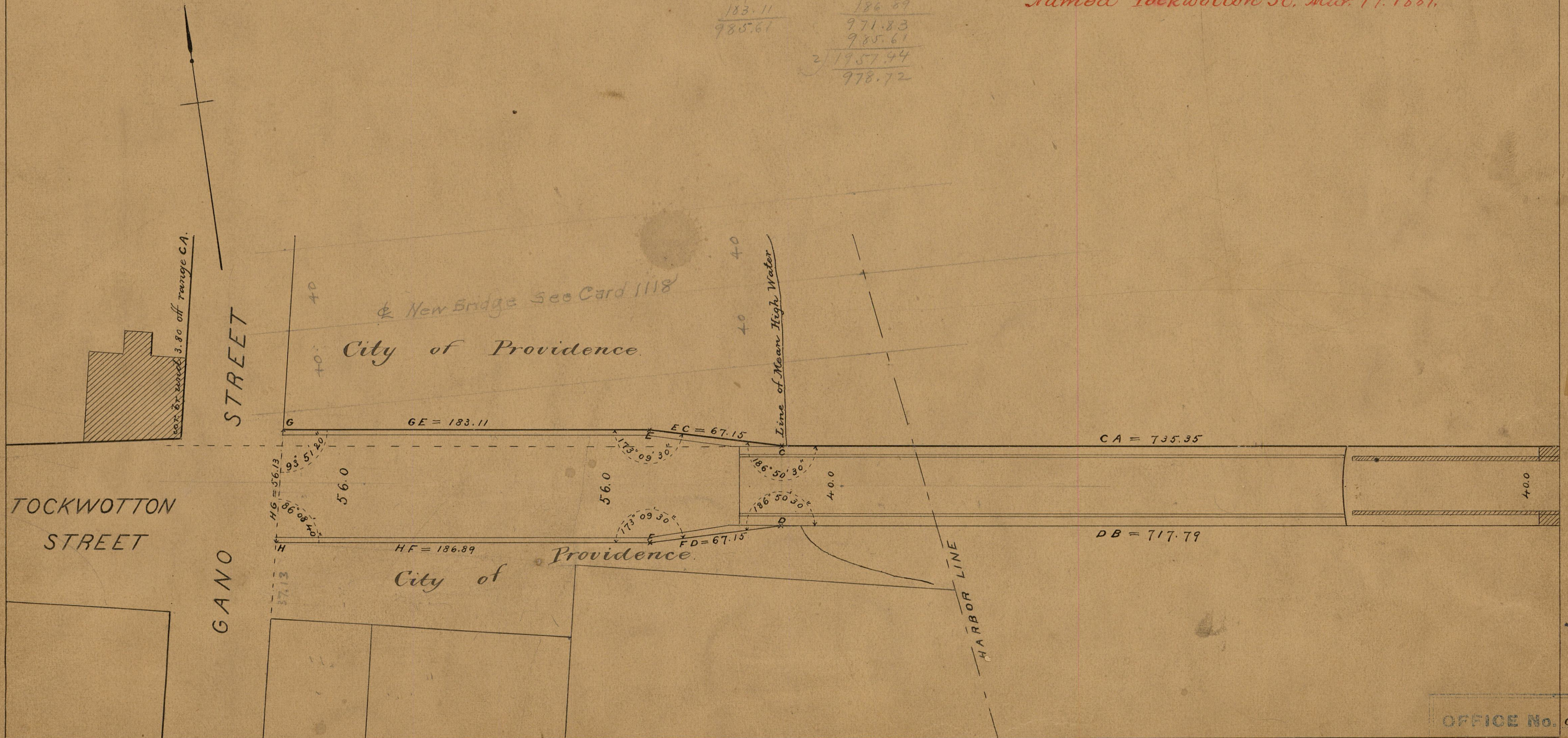

83
A-29

OFFICE No. 8946
DRAWER „ 83
SHEET „ A-29

83
A-29